

Industries Served:

- Pulp & paper
- CO-Generation
- Mining/Oil & Gas
- Cement
- Potash

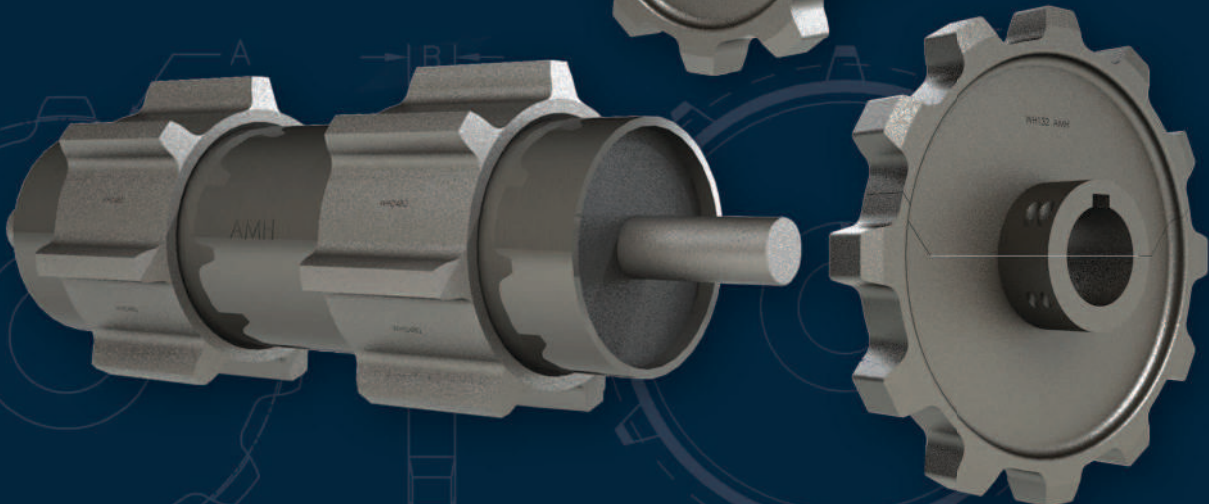

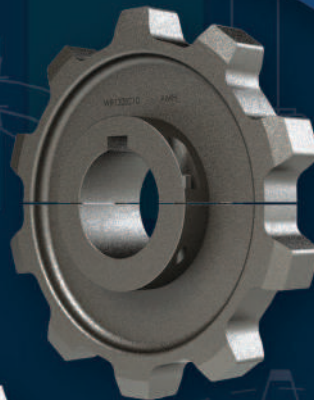
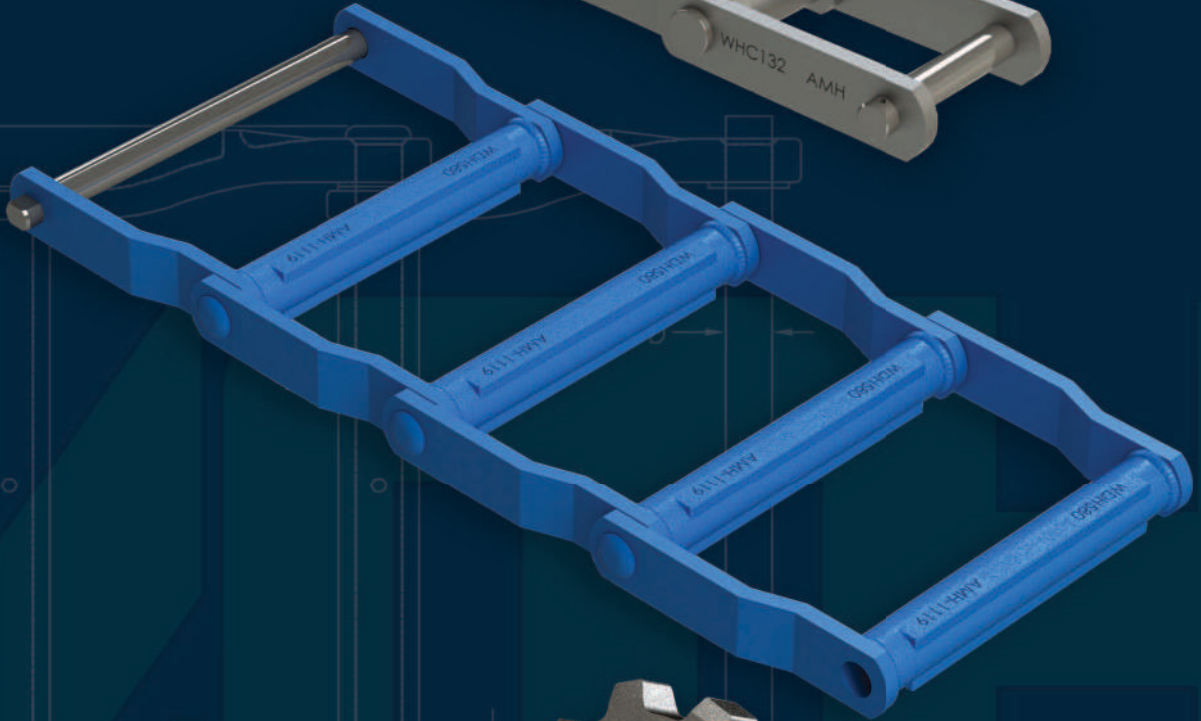
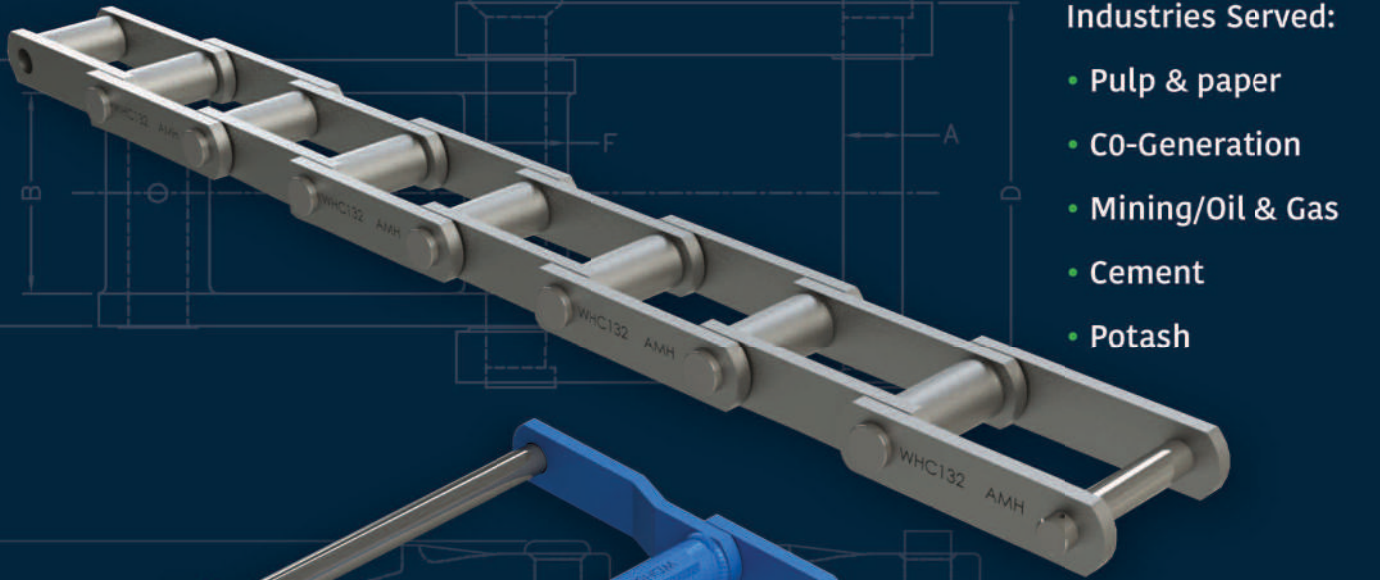

AMH cast mill / drag chains can be cast in various types of material such as: low alloy steel, manganese, and heat resistant HN stainless steel. Our cast chain product line is a premium product in today's marketplace. Some of the features and benefits of these types of chains are: thicker cross sections in critical areas, tighter pin-to-barrel fit, and no welding of barrels or attachments.

C-Class

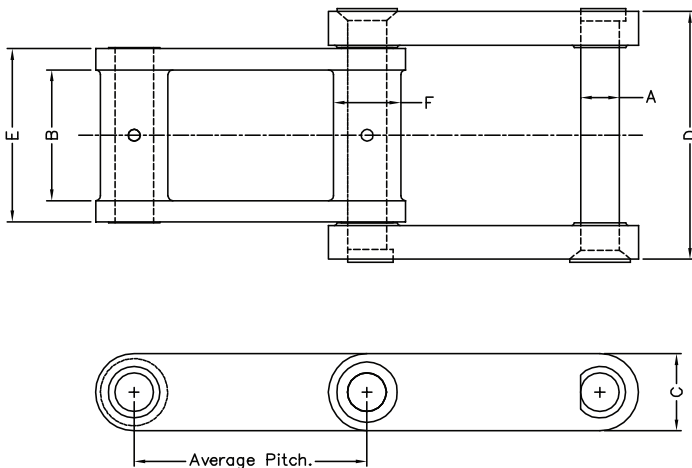

H-Class

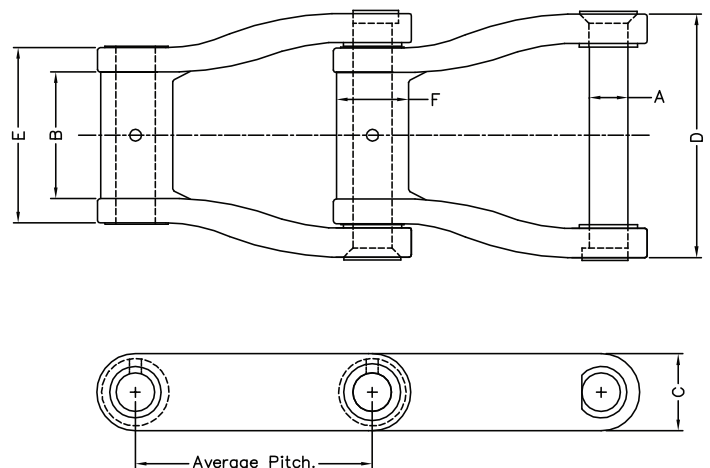

C-Class

Chain Type	Average Pitch	Average Ultimate Strength (LBS)	Maximum Working Load (LBS)	A	B	C	D	E	F	Weight/Ft (LBS)
				Inches						
C-124	4.00	22,800	148,000	7/8	2	2	4 3/4	3	1 5/8	15
C-132	6.05	32,800	214,000	1	3	2	6 1/2	4 1/2	1 3/4	18
C-155	6.05	35,000	230,000	1 1/8	3 1/4	2 1/2	6 1/2	4 1/4	1 3/4	22
C-157	6.05	41,800	270,000	1 1/4	2 3/4	2 3/4	6 1/2	5	2	25

H-Class

Chain Type	Average Pitch	Average Ultimate Strength (LBS)	Maximum Working Load (LBS)	A	B	C	D	E	F	Weight/Ft (LBS)
				Inches						
H-124	4.00	81,000	13,500	3/4	1-1/2	1-9/16	4-3/4	2-15/16	1-7/16	11
H-106	6.00	111,000	18,600	7/8	1-7/8	2	4-5/8	3-1/8	2	12
H-132	6.05	145,000	24,200	1	3	2	6-1/2	4-1/2	1-3/4	18
HD-132	6.05	183,000	30,500	1-1/8	2-3/4	2-1/4	6-3/4	4-3/8	2-1/4	26
HD-157	6.121	226,000	37,500	1-1/4	3-1/8	2-3/4	6-1/2	4-3/4	2-1/8	28



Cast Drag Chains

Our cast integral chain links eliminate any heat-affected zones and stress caused by welding. These cast chains can be produced with any type of standard or non-standard attachments. AMH can custom design these chains specifically to your application to provide extended chain life and reduced overall costs

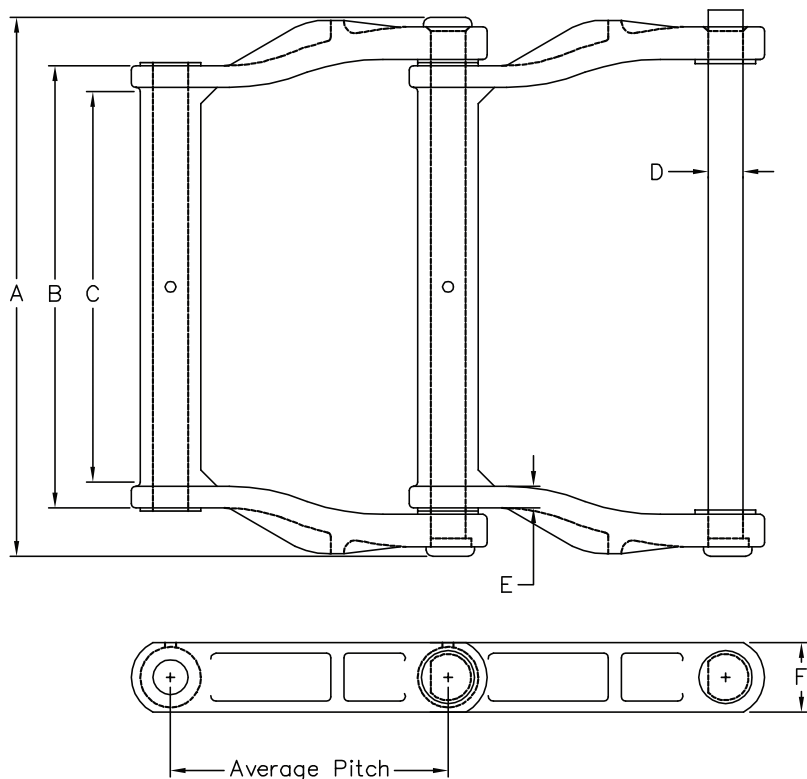

HD480 Cast Drag Chain AMH HD480 chains come in Cast Alloy 8630 QT380-400 material. Our chain is assembled using machined 4140 through-hardened pins with riveted construction. This chain features a cast integral sidebar making this link one piece fully cast. Chain comes with center point pre-greased barrel and 1" rivet.

Chain Type	Average Pitch	Average Ultimate Strength (LBS)	Maximum Working Load (LBS)	A	B	C	D	F	Weight/Ft (LBS)
				Inches					
HD-110	6.000	81,000	13,500	12.625	10.625	9	0.75	1.5	18
HD-480	8.000	145,000	24,200	15.5	12.875	11	1	2	34
HD-580	8.000	162,000	27,000	14.562	12.656	11.406	1	2	34
HD-680	8.000	226,000	37,600	14.562	12.781	12.687	1.25	2.25	38



Welded Steel Mill Chains

AMH welded steel mill chains are stocked with heat-treated and deep-induction-hardened pins, bushings and sidebars. Our weld steel chain offers optimum performance life in heavy-duty applications. Other material selections and heat treatment specifications are made to order. Please contact us to discuss your application.

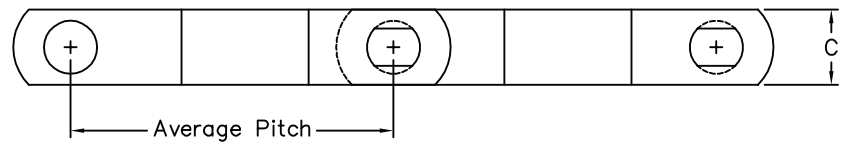
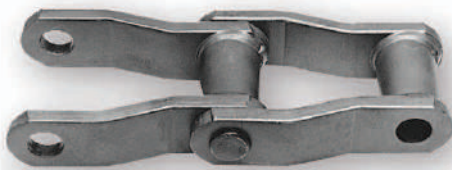
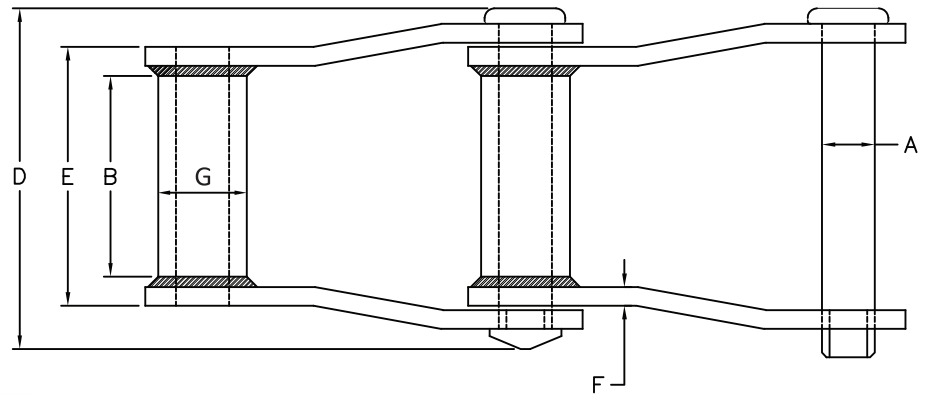

Welded Steel Mill Chain

Chain Type	Average Pitch in Inches	Average Ultimate Strength (LBS)	Maximum Working Load (LBS)	A	B	C	D	E	F	G	Weight/Ft (LBS)
				Inches							
WH78	2.609	20,000	3000	0.5	1.5	1.18	2.875	2	0.25	0.875	4
WH78XHD	2.640	42,700	3940	0.56	1.25	1.25	3.189	2	0.375	1	6.5
WH82XHD	3.075	62,000	5900	0.75	1.65	1.5	3.85	2.395	0.375	1.25	9.2
WH124	4.000	69,000	7200	0.75	1.5	1.5	4.25	2.75	0.375	1.25	7.8
WH124XHD	4.063	129,000	11,375	1	1.5	2	4.875	3	0.5	1.625	14.6
WH106	6.000	69,000	7200	0.75	1.5	2	4.875	2	0.375	1.25	7
WH106XHD	6.050	115,000	10,500	1	1.5	2	4.875	3	0.5	1.75	11.8
WH132	6.050	115,300	15,300	1	2.75	2	6.375	4.40625	0.5	1.75	14.2
WH132XHD	6.050	182,000	17,000	1	2.75	2	6.75	4.65625	0.625	1.75	18.6
WH166	6.000	69,000	9,600	1	2	1.625	4.35	2.75	0.375	1.75	8.5
WH150	6.050	116,000	15,300	1	2.75	2.5	6.5	4.40625	0.5	1.75	16.8
WH155	6.050	145,000	17,750	1.1875	2.75	2.5	6.8125	4.4375	0.5625	1.75	19
WH157	6.050	161,000	18,200	1.1875	2.75	2.5	6.75	4.625	0.625	1.75	20.6
WH159	6.125	230,000	20,250	1.25	3.375	3	6.75	4.625	0.625	1.9	26.5



We have designed our chains with tight press-fit rivets that create optimal residual stress in sidebars and maximize chain life. AMH can design and fabricate various attachments with our in house CNC cutting table and CNC milling machines.

AMH 580 Hybrid Drag Chain features a full round cast alloy barrel with plow face cast into the barrel and welded steel sidebars. This seamless heavy cast barrel is more than double the industry standard 0.46" thick and comes with 1" full round riveted style pin. The pin keeps full contact with the entire length of the barrel giving it more bearing surface, which prevents wear. The barrel is cast alloy 8630M quenched and tempered to 350-380BHN and precision machined to keep the tightest pin to barrel tolerance throughout the full length of the barrel. Sidebars are fully heat-treated with tight press fits. This chain is a great alternative to the fully cast chain and would be expected to last nearly the same life span.

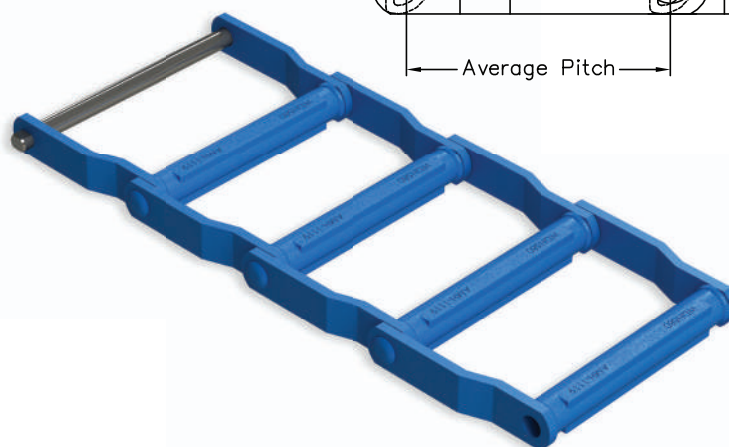
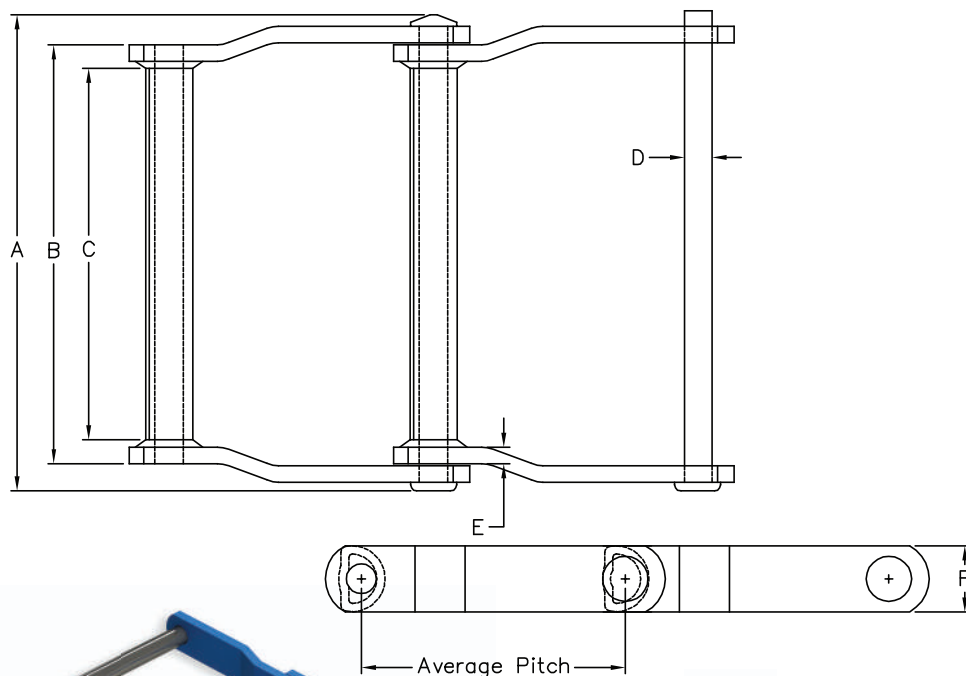

Chain Type	Average Pitch in Inches	Average Ultimate Strength (LBS)	Maximum Working Load (LBS)	A	B	C	D	E	F	Weight/Ft (LBS)
				Inches						
WDH110	6.000	60,000	10,200	11.8	10.38	9	0.75	0.375	1.5	12
WDH116FRB	8.000	69,000	11,000	15.75	14.125	13	0.875	0.375	1.75	14.5
WDH118	8.000	85,000	17,000	15.98	14.91	13.25	1	0.5	2	19.8
WDH120XHD	6.000	134,000	22,300	12.53	10.5	9.25	1	0.625	2	24.5
WDH480	8.000	95,500	15,000	14.6	12.75	11.2	0.875	0.5	2	19.5
WDH480FRB	8.000	122,000	24,400	14.6	12.75	11.2	1	0.5	2	21
*WDH580HYB	8.000	114,000	21,000	14.6	12.75	11.25	1	0.5	2	22.8
WDH580HYBXHD	8.000	134,000	22,300	15.125	13	11.75	1	0.625	2	24.3
WDH680	8.000	134,000	22,300	15.33	13	11.2	1	0.625	2	21



Welded Steel Drag Chains

WDH480FRB Welded Steel Drag Chain

features a full round barrel on our WDHFRB 480 Chain. This seamless heavy wall is almost double the industry standard 0.40" thick. This chain comes with 1" full round press-fit pins for a tight pin to barrel tolerance. The pin has full contact with the entire length of the barrel which gives it more bearing surface, preventing wear. The pin-to-barrel tolerance is much tighter than the standard welded drag chain, which increases life of the components.

All parts are fully heat treated.

Chain can also be run in either direction and will run on existing sprockets.

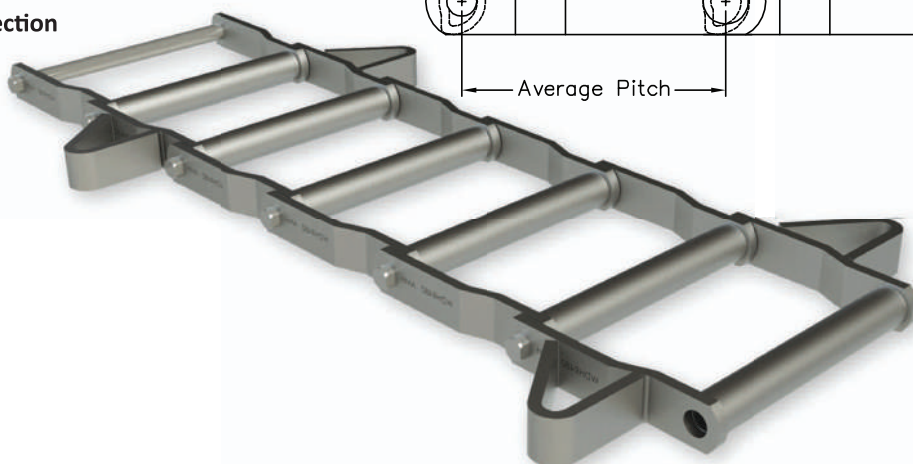
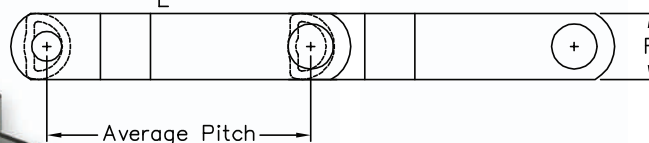
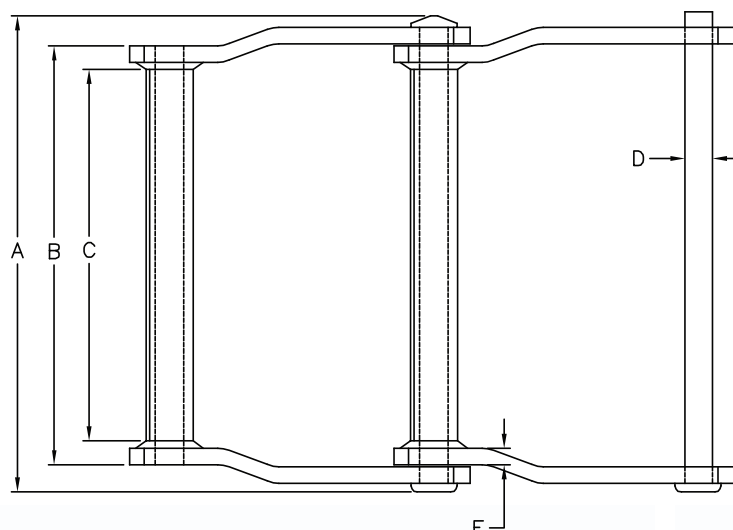

Chain Type	Average Pitch in Inches	Average Ultimate Strength (LBS)	Maximum Working Load (LBS)	A	B	C	D	E	F	Weight/Ft (LBS)
				Inches						
WDH110	6.000	60,000	10,200	11.8	10.38	9	0.75	0.375	1.5	12
WDH116FRB	8.000	69,000	11,000	15.75	14.125	13	0.875	0.375	1.75	14.5
WDH118	8.000	85,000	17,000	15.98	14.91	13.25	1	0.5	2	19.8
WDH120XHD	6.000	134,000	22,300	12.53	10.5	9.25	1	0.625	2	24.5
WDH480	8.000	95,500	15,000	14.6	12.75	11.2	0.875	0.5	2	19.5
* WDH480FRB	8.000	122,000	24,400	14.6	12.75	11.2	1	0.5	2	21
WDH580HYB	8.000	114,000	21,000	14.6	12.75	11.25	1	0.5	2	22.8
WDH580HYBXHD	8.000	134,000	22,300	15.125	13	11.75	1	0.625	2	24.3
WDH680	8.000	134,000	22,300	15.33	13	11.2	1	0.625	2	21

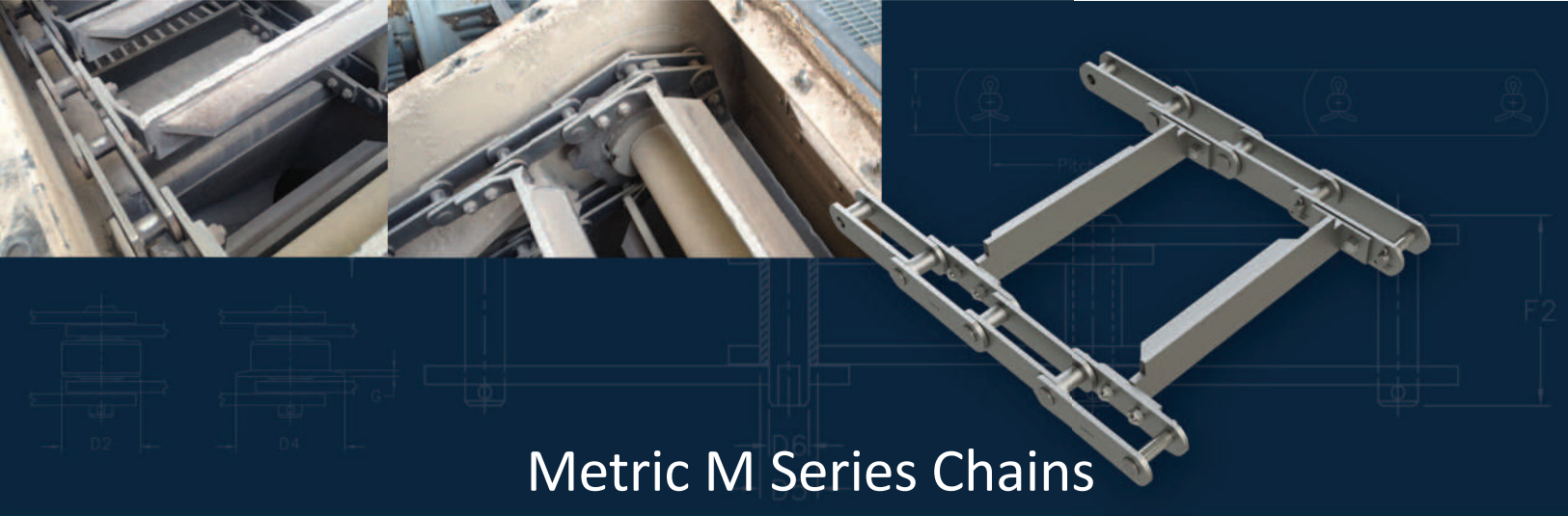

Metric M Series Chains

Our engineered metric Class M Series chains are developed to European Standards DIN 8167. These chains can be difficult to find or have long delivery lead times when you are forced to purchase them from the conveyor system OEM. AMH stocks a wide range of sizes of these chains.

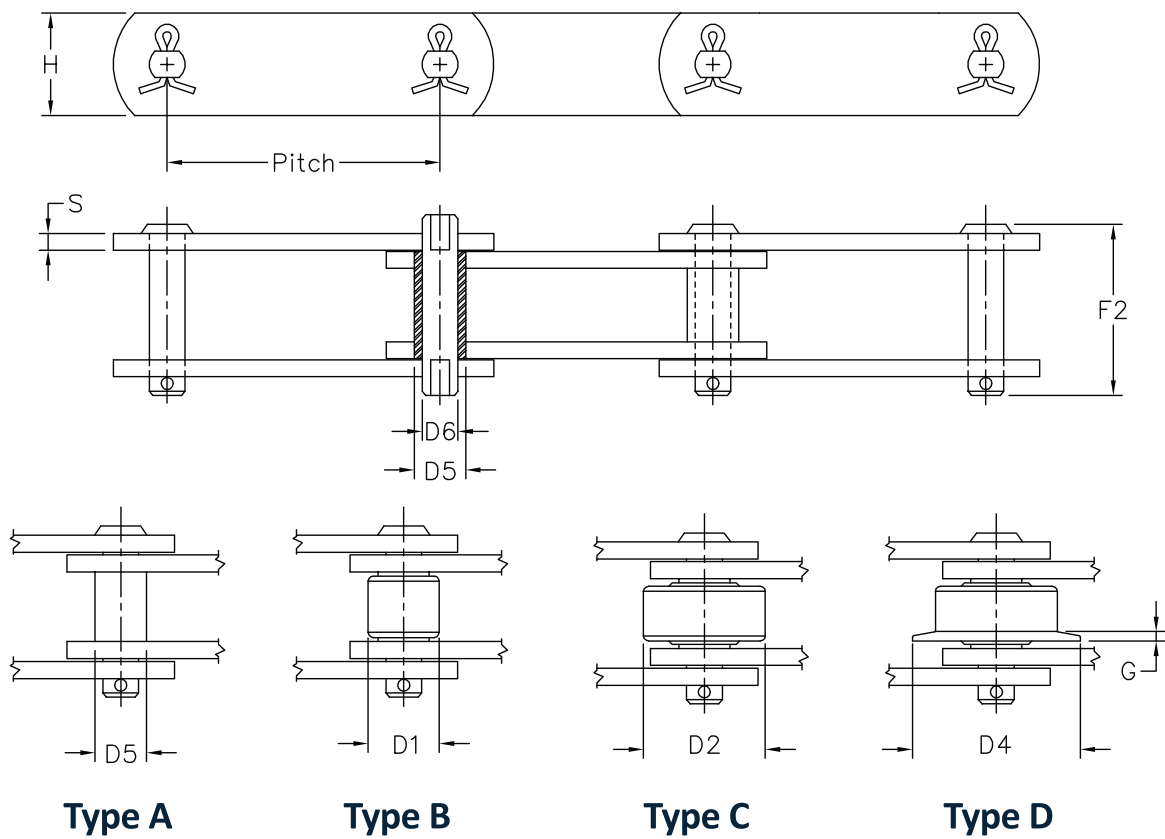

Chain Type	Average Pitch (mm)					Working Load (KN)	Rollers (mm)			Flange Thickness (mm)	Pin Dia. (mm)	Bushing Dia. (mm)	Over all Pin & Cotter (mm)	Sidebars (mm)	
							D1	D2	D4	G	D6	D5	F2	Thickness - S	Height - H
M80	100	125	160	200	250	125	25	50	60	7.0	12	18	31	5	35
M112	80	100	125	160	200	175	30	60	75	7.5	15	21	36	6	40
M160	100	125	160	200	250	260	36	70	90	8.5	18	25	41	7	50
M224	125	160	200	250	315	340	42	85	105	10.0	21	30	47	8	60
M315	160	200	250	315	400	520	50	100	124	10.5	25	36	57	10	70
M450	200	250	315	400	630	700	60	120	149	11.5	30	42	70	12	80



AMH sprockets are made from AR400 BHN plate. They can be supplied in several different sizes and hub configurations. Our in-house drafting department will design sprockets specific to your requirement. We offer the shortest lead time in the industry. We are able to do this with our wide range of AR400 plate inventory, in house burning table, CNC mill and lathe.

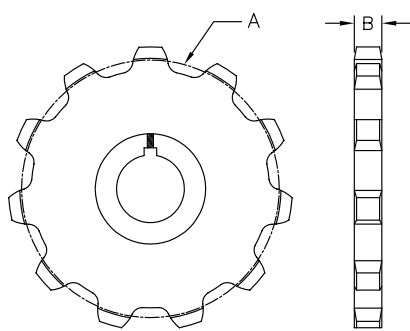

Mill Chain Sprocket

Chain Type	Number of Teeth	Pitch Dia. (Inches)	Tooth Face (Inches)
		A	B
WH-111	8	12.44	2
	9	13.91	2
	10	15.4	2
	11	16.9	2
	12	18.39	2
	13	19.89	2
WH-106 WH-106XHD	8	15.68	1-1/2
	9	17.54	1-1/2
	10	19.42	1-1/2
	11	21.3	1-1/2
	12	23.18	1-1/2
	13	25.07	1-1/2
WH-124 WH-124XHD	8	10.62	1-1/2
	9	11.88	1-1/2
	10	13.15	1-1/2
	11	14.42	1-1/2
	12	15.7	1-1/2
	13	16.98	1-1/2
WH-132 WH-132XHD WH-150 WH-155 WH-157	8	15.81	2-3/4
	9	17.69	2-3/4
	10	19.58	2-3/4
	11	21.47	2-3/4"
	12	23.38	2-3/4"
	13	25.28	2-3/4"

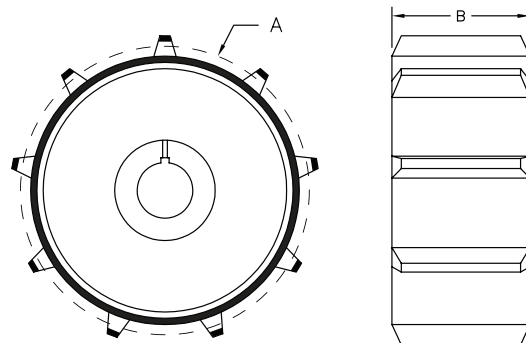

Drag Chain Sprocket

Chain Type	Number of Teeth	Pitch Dia. (Inches)	Tooth Face (Inches)
		A	B
WDH-110	6	12.00	9
	7	13.82	9
	8	15.68	9
	9	17.54	9
	10	19.42	9
	11	21.30	9
WDH-480	6	16.00	11
	7	18.44	11
	8	20.90	11
	9	23.39	11
	10	25.88	11
	11	28.40	11

